



# Rushcliffe Oaks

Celebrating life and honouring every memory





# Celebrating LIFE & Honouring every Memory

*Beautifully situated in the heart of the countryside, Rushcliffe Oaks provides a peaceful, welcoming setting for celebrations of life and expressions of remembrance.*

The environmentally-conscious building has a spacious, reflective Ceremony Hall with gentle lighting and full-height windows looking out across the peaceful memorial grounds. With its calm, dignified atmosphere and natural setting, Rushcliffe Oaks is a fitting place in which to celebrate life and say goodbye.

Our team are always on hand to provide any assistance you may require, so please do not hesitate to contact us.





## Services at Rushcliffe Oaks

The Ceremony Hall at Rushcliffe Oaks is a light and tranquil space catering for every requirement, from a simple, personal service to larger celebrations of life. The hall seats up to 120 people in its usual arrangement, but can be tailored to suit individual requirements, such as a more intimate U-shaped arrangement for a smaller family event.

Our one hour service allocations are spaced throughout the day to allow for an unhurried atmosphere, acknowledging the importance of every ceremony.

Service times are available at: *9.30am, 10.45am, 12.00pm, 1.15pm, 2.30pm and 3.45pm.*



## Waiting Area

Our airy, indoor waiting area provides comfortable seating for up to 15 people, with plentiful standing room for more.

A water cooler is provided and an accessible toilet is located nearby.

## Lobby & Partition

The sizeable lobby is separated from the Ceremony Hall by a sliding glass partition with privacy blinds. When required, this can be opened to create one large space that can accommodate upwards of 200 people. In the event of even greater attendance, sound from the service can be relayed outside to the sheltered area under the porte cochere.



## Family Room

For those who may need it, we offer a more relaxed, welcoming family room where the service can be viewed and listened to via a large television screen.

## Flower Court

On exiting the Ceremony Hall at the end of a service, attendees can gather in our spacious flower court where floral tributes will be placed. Variable-roofed pergolas can be closed to provide shelter from inclement weather, or left open on finer days.

## Viewing Lobby

A viewing lobby into the Crematory Hall is available for those wishing to book a service incorporating a witnessed charge. There is space in this room for up to 20 people.

# The Rushcliffe Oaks Memorial Grounds

The grounds at Rushcliffe Oaks are divided into two distinct areas for remembrance — the Acorn Gardens and the Quercus Woodland.

Throughout both, sensitive memorialisation options allow for personal expressions of remembrance, providing for dignified reflection amidst tranquil serenity.

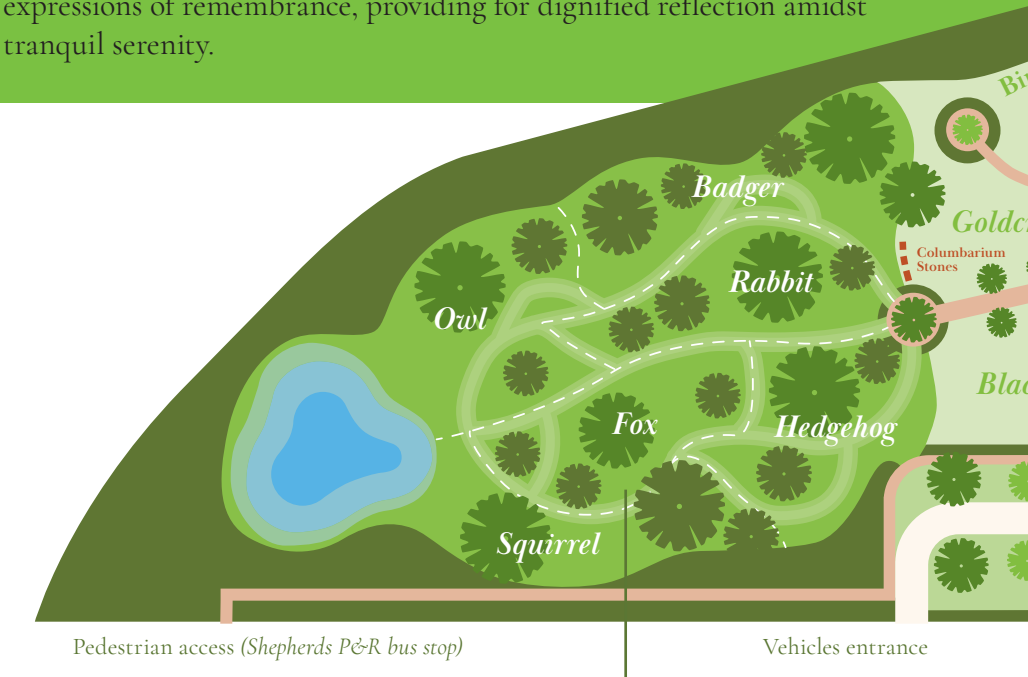

## Quercus Woodland

At the northern end of the site, paths radiate down from the formal Acorn Gardens into the tranquil environs of the Quercus Woodland. This green and pleasant habitat will include wildflower meadows and broad-leaved trees, and is maintained with an emphasis on supporting wildlife and encouraging bio-diversity.

The area is divided into six informal sections, each named after native British animals – *Badger*, *Fox*, *Hedgehog*, *Owl*, *Rabbit* and *Squirrel*.

Pathways will provide access amongst the trees and undulations, with eight memorial benches planned to be installed for reflection and remembrance.

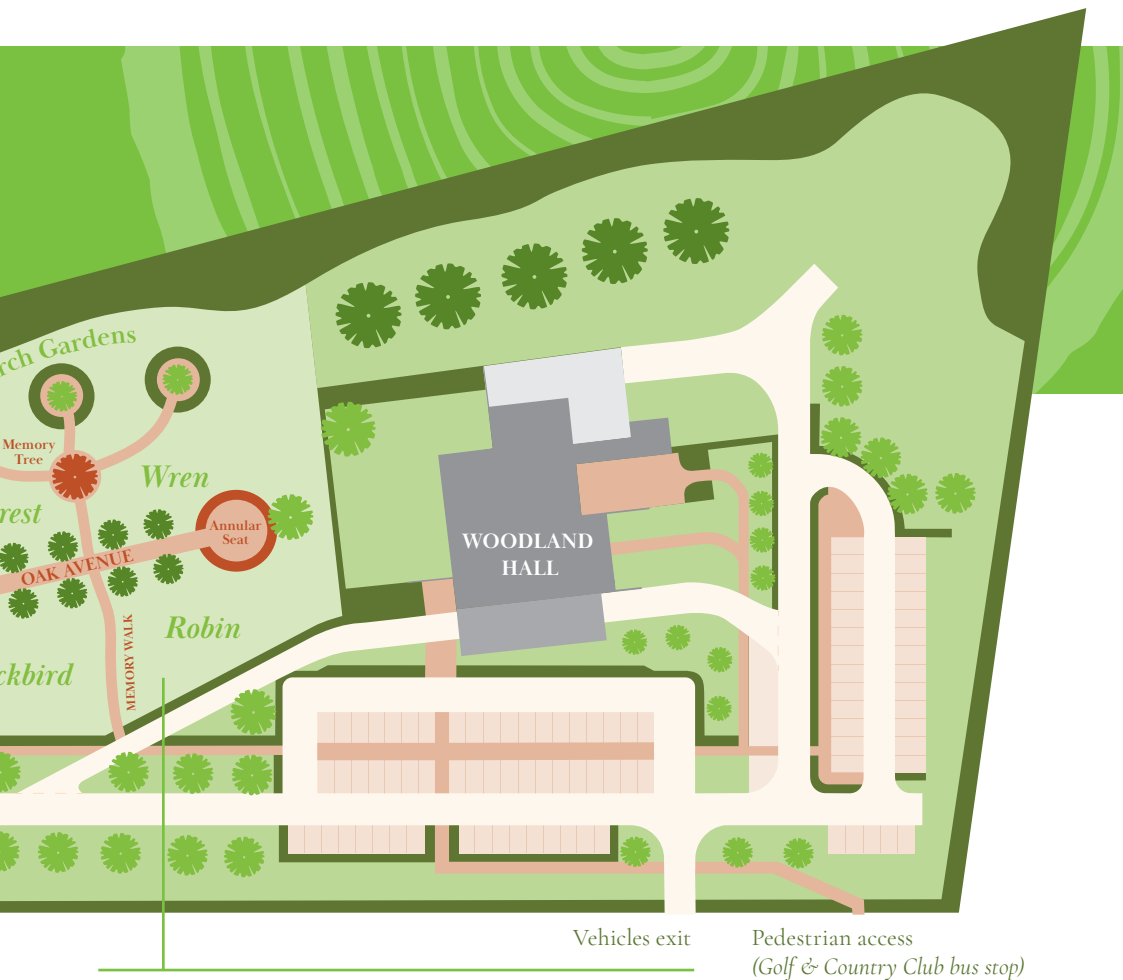

## Acorn Gardens

The peaceful formal gardens are divided by the Oak Avenue and the Memory Walk, creating four distinct memorial lawns – *Goldcrest*, *Wren*, *Blackbird*, and *Robin*.

Beyond the Avenue the Memory Walk leads to the striking Memory Tree, and then further in three short sections to circular Birch gardens. Round each of these, memorial benches are available for quiet reflection. The Oak Avenue itself is lined by memorial kerbs and to the south leads to the Annular Seat – an impressive 10-metre-wide circular bench comprising over 300 engravable memorial slats. Close to the north end of the Avenue, marking the boundary with the *Quercus* Woodland, stand three Columbarium Stones for the interment of ashes.



---

## After the Service

Once the funeral is over your attention will turn to your wishes regarding your loved one's ashes.

During the arrangement of the cremation you will have filled in a form indicating your wishes, but with time to reflect you may find your preference has changed. There is no obligation to adhere to your initial instructions, so you should ensure that your Funeral Director or the crematorium are instructed to hold onto the ashes for a time.

Should you choose to change your mind a simple written instruction will ensure that we are able to follow your updated instructions. We do recommend that you take your time with this decision.





## The Scattering of Ashes

Should your preference be for your loved one's ashes to be scattered in the memorial grounds, there are areas for this in both the Acorn Gardens and the Quercus Woodland. You have the option of whether you would prefer to be present at the time.

### Witnessed Scatterings

If you do wish to be present, arrangement will be made for a suitable date and time. On the day we will meet you at Reception and an Attendant will accompany you to your chosen location. You may choose to perform the scattering yourself or for our Attendant to do it for you. You might also like to consider anything you wish to be said at the scattering.

### Unwitnessed Scatterings

Unwitnessed scatterings will take place up to three months after the cremation and will be performed with the same dignity and respect as if you were present.

The location of scattering will be recorded and you will be sent a confirmatory Certificate of Scattering.



## Interment Options

Your preference may be for your loved one's ashes to be retained within a memorialisation. Rushcliffe Oaks provides a number of attractive options for interment.

- Columbarium Stone niches are available within the Acorn Gardens
- Stone Orbs accommodating one, two or four sets of ashes can be placed in the Acorn Gardens or the Quercus Woodland.
- Similarly sized wooden Log Orbs can also be situated in the Quercus Woodland.

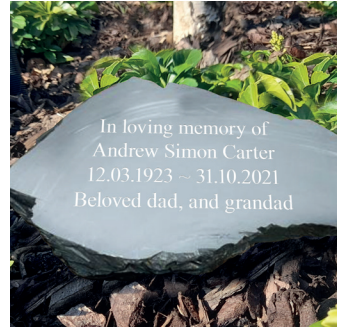

## Engraved Memorials

There are many options for lasting memorialisation in the form of engraved inscriptions on plaques and other items. The Oak Avenue in the Acorn Gardens has been designed to be lined with memorial plaques and there are bench, stake and slate plaques available in both the gardens and the woodland.

At one end of Oak Avenue is the Annular Seat where individual slats can be personally engraved, or golden leaves are available on our Memory Tree.

*To see all our available options please ask for a Memorialisations brochure.*



## How to Find Us

### By road:

Rushcliffe Oaks is located 6 miles to the south-east of Nottingham.

- *From Nottingham*; follow the A52 past the Gamston roundabout. After 2½ miles turn right at the traffic lights onto Stragglethorpe Road, then right onto Main Road.
- *From the A46 at Bingham*; follow the A52 past Radcliffe-on-Trent. After the old railway bridge turn left at the traffic lights onto Stragglethorpe Road, then right onto Main Road.
- *From the south*; follow the A46 past the exit for Cotgrave to the slip-road exit for Cropwell Butler / Cropwell Bishop and turn left at the roundabout onto Stragglethorpe Road. After about 2 miles, pass under the old railway bridge and turn left onto Main Road.

*The Rushcliffe Oaks entrance is the first gateway on the left.*



# Rushcliffe Oaks

Main Road, Stragglethorpe,  
Nottingham, NG12 2PY

0115 914 8557

info@rushcliffeoaks.co.uk

www.rushcliffeoaks.co.uk



Rushcliffe  
Borough Council

### By public transport:

The *Cotgrave* bus service runs every 20 minutes during the day from the centre of Nottingham. Use the *Golf & Country Club* stop for Rushcliffe Oaks. Travel time from Nottingham bus or railway station is approximately 20 minutes.

### By bicycle:

Rushcliffe Oaks is also adjacent to the Radcliffe-on-Trent to Cotgrave Country Park cycle way, and has bicycle hoops available on site.